

# Tank Top Mounted

## PI 500 SERIES

- Aluminium headed filter with plastic bowl (60-160 l/min) or steel bowl (160-1000 l/min).
- All units rated to 10 bar and designed for tank top mounting for return line flow
- High retention rate, low pressure drop elements
- BSPP porting for models up to 400 l/min, SAE flange for 630 -1000 l/min
- Optional combined breather available upon request (63 to 100l/min)

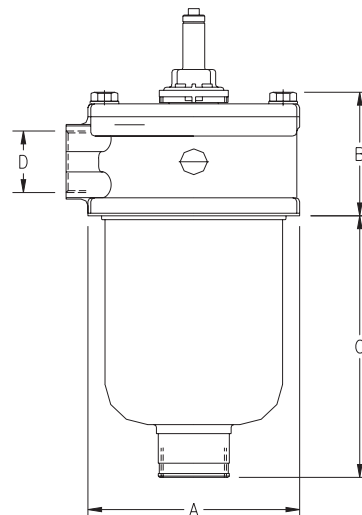

part number	part number	part number	part number	part number	part number
<b>63 l/min</b>	<b>A = 115 mm</b>	<b>B = 77mm</b>	<b>C = 191 mm</b>	<b>D = G1</b>	<b>Mass = 0.7 kg</b>
PI 50006 - 57					
PI 50006 - 57 MIC 10		PI 50006 - 57 SMX 3		PI 50006 - 57 SMX 10	
PI 50006 - 57 MIC 25		PI 50006 - 57 SMX 6		PI 50006 - 57 SMX 25	
<b>100 l/min</b>	<b>A = 115 mm</b>	<b>B = 77 mm</b>	<b>C = 281 mm</b>	<b>D = G1</b>	<b>Mass = 0.75 kg</b>
PI 50010 - 57					
PI 50010 - 57 MIC 10		PI 50010 - 57 SMX 3		PI 50010 - 57 SMX 10	
PI 50010 - 57 MIC 25		PI 50010 - 57 SMX 6		PI 50010 - 57 SMX 25	
<b>160 l/min</b>	<b>A = 151 mm</b>	<b>B = 94 mm</b>	<b>C = 207 mm</b>	<b>D = G1½</b>	<b>Mass = 2.8 kg</b>
PI 50016 - 57					
PI 50016 - 57 MIC 10		PI 50016 - 57 SMX 3		PI 50016 - 57 SMX 10	
PI 50016 - 57 MIC 25		PI 50016 - 57 SMX 6		PI 50016 - 57 SMX 25	
<b>250 l/min</b>	<b>A = 151 mm</b>	<b>B = 94 mm</b>	<b>C = 297 mm</b>	<b>D = G1½</b>	<b>Mass = 4.2 kg</b>
PI 50025 - 57					
PI 50025 - 57 MIC 10		PI 50025 - 57 SMX 3		PI 50025 - 57 SMX 10	
PI 50025 - 57 MIC 25		PI 50025 - 57 SMX 6		PI 50025 - 57 SMX 25	
<b>400 l/min</b>	<b>A = 180 mm</b>	<b>B = 118 mm</b>	<b>C = 309 mm</b>	<b>D = DN 51</b>	<b>Mass = 6.4 kg</b>
PI 50040 - 57					
PI 50040 - 57 MIC 10		PI 50040 - 57 SMX 3		PI 50040 - 57 SMX 10	
PI 50040 - 57 MIC 25		PI 50040 - 57 SMX 6		PI 50040 - 57 SMX 25	
<b>630 l/min</b>	<b>A = 180 mm</b>	<b>B = 118 mm</b>	<b>C = 459 mm</b>	<b>D = DN 64</b>	<b>Mass = 7.2 kg</b>
PI 50063 - 57					
PI 50063 - 57 MIC 10		PI 50063 - 57 SMX 3		PI 50063 - 57 SMX 10	
PI 50063 - 57 MIC 25		PI 50063 - 57 SMX 6		PI 50063 - 57 SMX 25	
<b>1000 l/min</b>	<b>A = 207 mm</b>	<b>B = 149 mm</b>	<b>C = 430 mm</b>	<b>D = DN 76</b>	<b>Mass = 10.6 kg</b>
PI 50100 - 57					
PI 50100 - 57 MIC 10		PI 50100 - 57 SMX 3		PI 50100 - 57 SMX 10	
PI 50100 - 57 MIC 25		PI 50100 - 57 SMX 6		PI 50100 - 57 SMX 25	

filter assemblies filter option	description
-58	Optional hirshmann connector to modify visual indicator into visual/electrical indicator